

3 PIECE, HEAVY DUTY, METAL-TO-METAL FEMALE ROD ENDS

TSFX

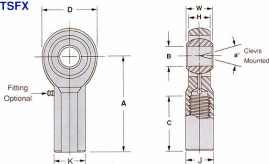

PART NO.		DIMENSIONS IN INCHES										Radial Static Load Cap. Lbs.	Approx. Brg. Wt. Lbs.	
Right Hand	Left Hand	B +0.015 -0.025	W +0.000 -0.005	H ±.005	A ±.010	D ±.010	K ±.010	J ±.010	Ball Dia. Ref.	C +0.002 -0.031	Thread UNF-2B			a° Misalign. Angle
TSFX3	TSFXL3	.1900	.312	.250	1.062	.625	.406	.312	.437	.562	10-32	13	3,733	.038
TSFX4	TSFXL4	.2500	.375	.281	1.312	.750	.469	.375	.500	.750	1/4-28	16	6,190	.059
TSFX5	TSFXL5	.3125	.437	.344	1.375	.875	.500	.437	.625	.750	5/16-24	14	7,639	.092
TSFX6	TSFXL6	.3750	.500	.406	1.625	1.000	.687	.562	.719	.937	3/8-24	12	9,544	.152
TSFX7	TSFXL7	.4375	.562	.437	1.812	1.125	.750	.625	.812	1.062	7/16-20	14	10,285	.198
TSFX8	TSFXL8	.5000	.625	.500	2.125	1.312	.875	.750	.937	1.187	1/2-20	12	15,336	.329
TSFX10	TSFXL10	.6250	.750	.562	2.500	1.500	1.000	.875	1.125	1.500	5/8-18	16	17,955	.477
TSFX12	TSFXL12	.7500	.875	.687	2.875	1.750	1.125	1.000	1.312	1.750	3/4-16	14	28,081	.723

PART NO.		DIMENSIONS IN MILLIMETERS										Radial Static Load Cap. Kilograms	Approx. Brg. Wt. Grams	
Right Hand	Left Hand	B +0.081 -0.127	W +0.000 -0.127	H ±.127	A ±.254	D ±.254	K ±.254	J ±.254	Ball Dia. Ref.	C +1.574 -0.787	Thread UNF-2B			a° Misalign. Angle
TSFX3	TSFXL3	4.83	7.92	6.35	26.97	15.88	10.31	7.92	11.10	14.27	10-32	13	1,693	17
TSFX4	TSFXL4	6.35	9.53	7.14	33.32	19.05	11.91	9.53	12.70	19.05	1/4-28	16	2,808	27
TSFX5	TSFXL5	7.94	11.10	8.74	34.93	22.23	12.70	11.10	15.88	19.05	5/16-24	14	3,455	42
TSFX6	TSFXL6	9.53	12.70	10.31	41.28	25.40	17.45	14.27	18.26	23.80	3/8-24	12	4,329	69
TSFX7	TSFXL7	11.11	14.27	11.10	46.02	28.58	19.05	15.88	20.62	26.97	7/16-20	14	4,665	90
TSFX8	TSFXL8	12.70	15.88	12.70	53.98	33.32	22.23	19.05	23.80	30.15	1/2-20	12	6,956	149
TSFX10	TSFXL10	15.88	19.05	14.27	63.50	38.10	25.40	22.23	28.58	38.10	5/8-18	16	8,144	216
TSFX12	TSFXL12	19.05	22.23	17.45	73.03	44.45	28.58	25.40	33.32	44.45	3/4-16	14	12,738	328

MATERIALS

BALL	RACE	BODY
S2100 STEEL R/C 56 MIN. HARD CHROME PLATED	STEEL ALLOY HEAT TREATED ZINC PLATED, CHROMATE TREATED	STEEL ALLOY HEAT TREATED ZINC PLATED, CHROMATE TREATED