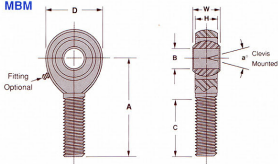

**MBM**

PART NO.		DIMENSIONS IN INCHES									Radial Static Load Cap. Lbs.	Approx. Brg. Wt. Lbs.
Right Hand	Left Hand	B	W	H	A	D	Ball Dia. Ref.	C	Thread UNF-3A	a° Misalign. Angle		
MBM3	MBML3	1.900 +0.015 -0.006	.312 +0.000 -0.005	.250 ±.005	1.250 ±.015	.625 ±.010	.437	.750	10-32	13	1,169	.028
MBM4	MBML4	2.500	.375	.281	1.562	.750	.500	1.000	1/4-28	16	2,158	.043
MBM5	MBML5	3.125	.437	.344	1.875	.875	.625	1.250	5/16-24	14	2,784	.072
MBM6	MBML6	3.750	.500	.406	1.938	1.000	.719	1.250	3/8-24	12	3,915	.112
MBM7	MBML7	4.375	.562	.437	2.125	1.125	.812	1.375	7/16-20	14	4,218	.160
MBM8	MBML8	5.000	.625	.500	2.438	1.312	.937	1.500	1/2-20	12	6,660	.249
MBM10	MBML10	6.250	.750	.562	2.625	1.500	1.125	1.625	5/8-18	16	7,364	.382
MBM12	MBML12	7.500	.875	.687	2.875	1.750	1.312	1.750	3/4-16	14	11,518	.602

PART NO.		DIMENSIONS IN MILLIMETERS									Radial Static Load Cap. Kilograms	Approx. Brg. Wt. Grams
Right Hand	Left Hand	B	W	H	A	D	Ball Dia. Ref.	C	Thread UNF-3A	a° Misalign. Angle		
MBM3	MBML3	4.83 +0.381 -0.127	7.92 +0.000 -0.127	6.35 ±.127	31.75 ±.381	15.88 ±.254	11.10	19.05	10-32	13	530	13
MBM4	MBML4	6.35	9.53	7.14	39.67	19.05	12.70	25.40	1/4-28	16	979	20
MBM5	MBML5	7.94	11.10	8.74	47.63	22.23	15.88	31.75	5/16-24	14	1,263	33
MBM6	MBML6	9.53	12.70	10.31	49.23	25.40	18.26	31.75	3/8-24	12	1,776	51
MBM7	MBML7	11.11	14.27	11.10	53.98	28.58	20.62	34.93	7/16-20	14	1,913	73
MBM8	MBML8	12.70	15.88	12.70	61.93	33.32	23.80	38.10	1/2-20	12	3,021	113
MBM10	MBML10	15.88	19.05	14.27	66.68	38.10	28.58	41.28	5/8-18	16	3,340	173
MBM12	MBML12	19.05	22.23	17.45	73.03	44.45	33.32	44.45	3/4-16	14	5,225	273

**MATERIALS**

BALL	RACE	BODY
CARBON STEEL- CASE HARDENED- CHROME PLATED	SINTERED PHOSPHOR BRONZE	LOW CARBON STEEL ZINC PLATED, CHROMATE TREATED